

110.9

111.0

EOV
WL 04.1

EOV
WL02.1

EOV
WL 02.1
WL 02.2

EDV
W/L O
W/L O
W/L O
W/L O

35x8

EOL

WL 01.4

18204.2

14202

4402

2/0  
65x150  
PVC 0110

102250

EOV  
WL 04.1  
WL 04.2

35x80

~~7e 516-1~~ - 8.60%

5.76%

52:829 m - k. BENZINA

Q 108

$$\begin{array}{r} - 3,7 \\ 52,82 \end{array}$$

0118

111



P/6

P/7

PK  
km 111072

P/8

PK  
km 111092

111.1

P/9

111.0

35x80

EOV

WL 01.1

WL 01.2

WL 02.1

WL 02.2

P/11

P/12

111.2

P/13

0.3

P/14

KO=20

EOV
WL 01.1
WL 01.2
WL 02.1
WL 02.2

35x80

EOV
WL 01.1
WL 01.2
WL 02.1
WL 02.2

Z/0  
65x150  
100x110

- 10.03% - 8.49% --  
83.85m 203.49m k.č.3

433 561

1187 50

$r_1 = 362.654m$

$r_1 = 574$

$r_2 = 579$

16.5m

80.426m

YLEČKA BENTINA  
280. edwar

silnice

2.62% 10.71%  
48.933m

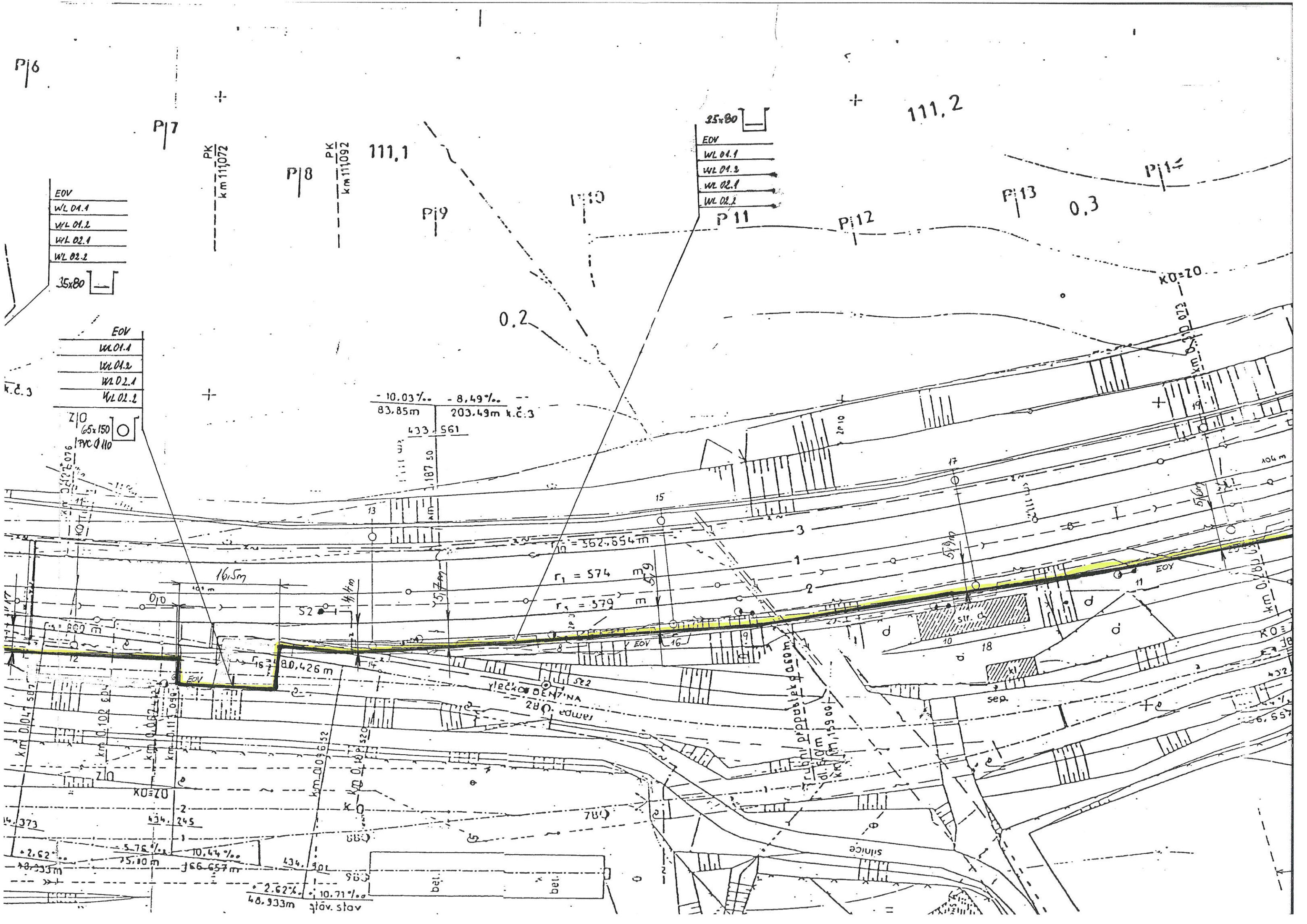



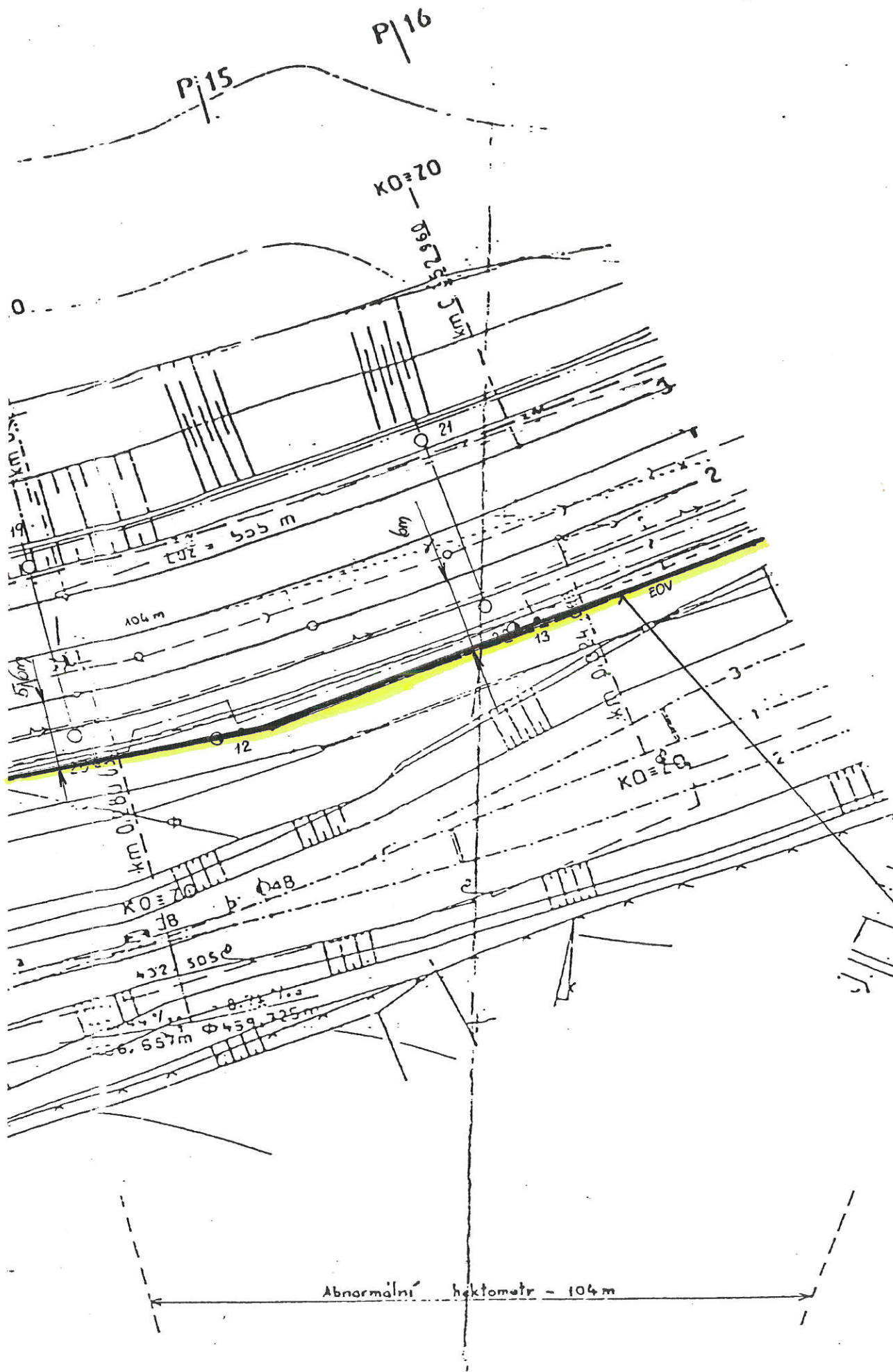

EO V
WL 01.1
WL 01.2
WL 02.1
WL 02.2
25x80

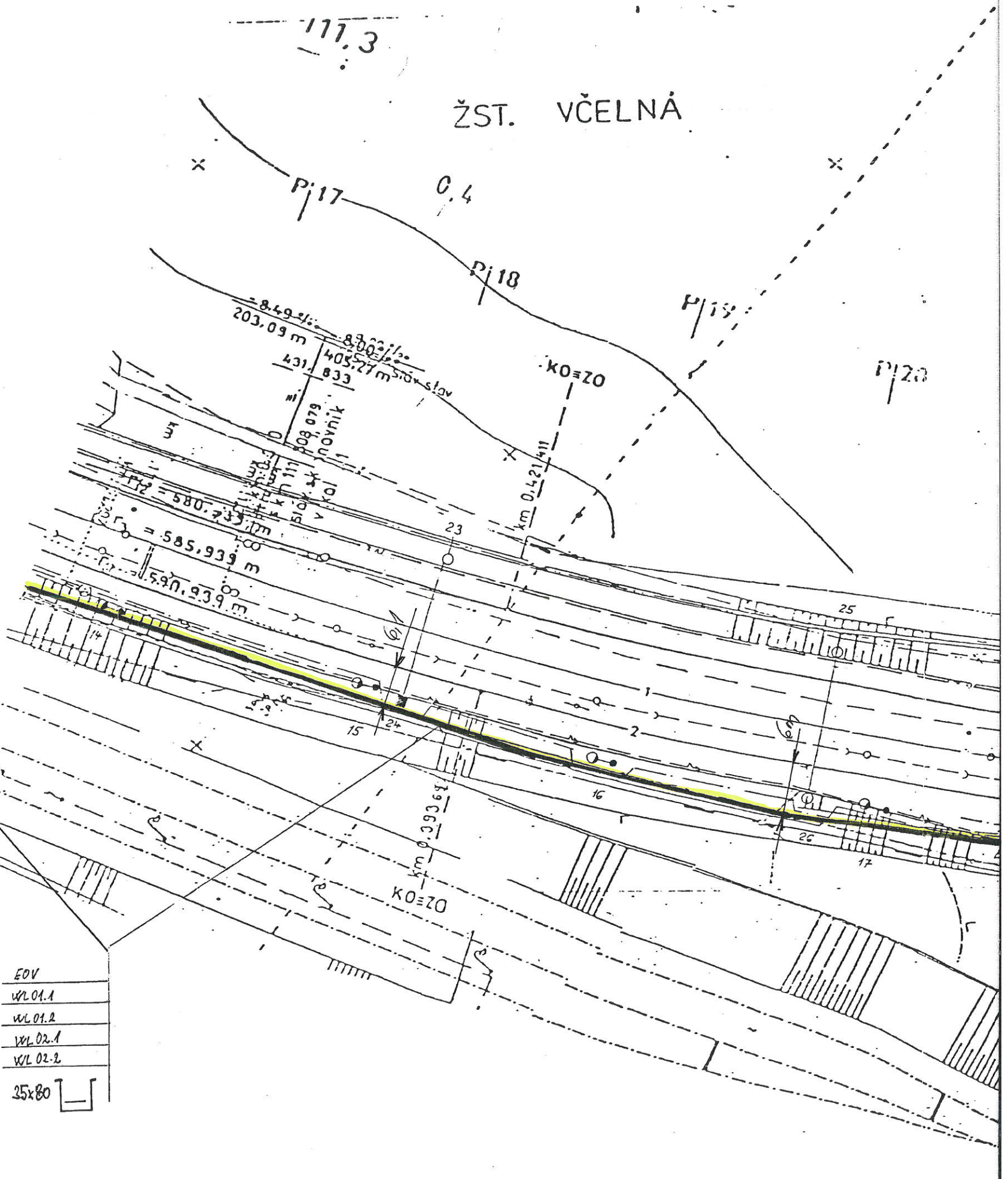



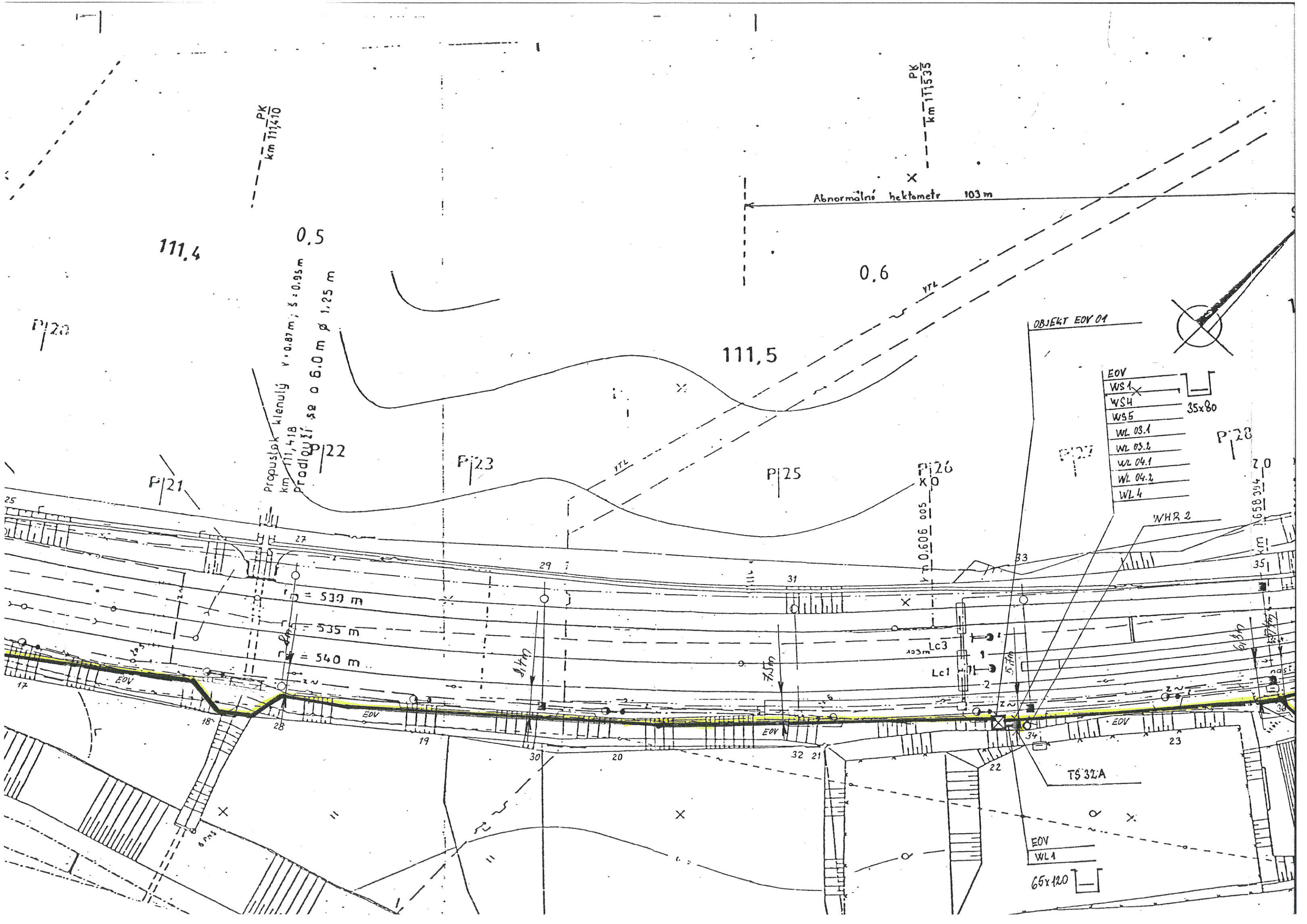

PK  
km 111,410

PK  
km 111,535

Abnormální hektometr 103 m

111,4

0,5

0,6

111,5

Propustek klenutý  $v = 0,87 \text{ m}$ ;  $s = 0,95 \text{ m}$   
km 111,418  
prodlouží se o 6,0 m ø 1,25 m

OBJEKT EDV 04

EOV	
WS 1	
WS 4	
WS 5	35x80
WL 03.1	
WL 03.2	
WL 04.1	
WL 04.2	
WL 4	

WHR 2

TS 32A

EOV  
WL 4  
65x120



